

NEW

## GOLIA MINI

IP67 IK07 CE    

TIPOLOGIA / TYPOLOGY

Proiettore | Projector

POSIZIONE INSTALLATIVA | INSTALLATION POSITION

**A terra, a parete, a soffitto o su pali/alberi**

Ground, wall, ceiling or poles/trees mounting

AMBIENTE INSTALLATIVO | INSTALLATION LOCATION

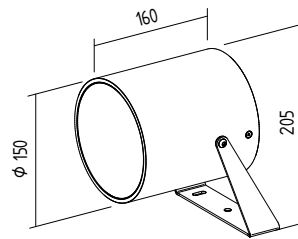
**Esterno | Outdoor**

GOLIA MINI

**36W**

kg 4,05

## CARATTERISTICHE ELETTRICHE | ELECTRICAL FEATURES

|                                       |  |
|---------------------------------------|--|
| POTENZA ASSORBITA   POWER CONSUMPTION | 36W  |
| ALIMENTAZIONE   POWER SUPPLY          | C.C.   |
| ALIMENTATORE   POWER SUPPLY UNIT      | 1050mA non incluso   not included                            |
| DIMMERAZIONE   DIMMING                | Dimmerabile Push, DMX, DALI, 1-10V<br>Push, DMX, DALI, 1-10V |
| COLLEGAMENTO   CONNECTION             | Serie   Series   |

## CARATTERISTICHE ILLUMINOTECNICHE | LIGHTING FEATURES

|  |  |
|--|--|
| COLORE LED   LED COLOUR                        | 2700K, 3000K, 4000K                          |
| INDICE RESA CROMATICA CRI   CRI                | >90  |
| OTTICHE   OPTICS                               | 11°, 19°, 38°                                |
| FLUSSO TOTALE NOMINALE<br>TOTAL NOMINAL LUMENS | 3924lm (2700K) 4140lm (3000K) 4536lm (4000K) |
| DURATA MEDIA LED   AVERAGE LED LIFE            | 50.000h L80 B10                              |

## CARATTERISTICHE MECCANICHE | MECHANICAL FEATURES

|                              |   |
|------------------------------|---|
| PESO   WEIGHT                | Kg 4,05   |
| FINITURE   FINISHES          | Bianco txt, Grigio txt, Nero txt, Corten, Antracite txt, Sand, Bronzo anodico opaco<br>txt White, txt Grey, txt Black, Corten, txt Anthracite, Sand, Anodic bronze matt   |
| INSTALLAZIONE   INSTALLATION | A terra, parete o soffitto con staffa verniciata (inclusa) o sabbiata (non inclusa),<br>a terra con picchetto (non incluso), su pali/alberi con cintura di fissaggio (non inclusa)<br>Floor, wall or ceiling mounting with varnished bracket (included) or sandblasted bracket<br>(not included), on ground with peg (not included), on poles / trees by mounting strap<br>(not included) |
| MATERIALE   MATERIAL         | Corpo in alluminio anticorrosivo verniciato, staffa in acciaio inox verniciato o<br>sabbiato, vetro temperato trasparente serigrafato<br>Varnished anticorrosive aluminium body, varnished or sandblasted stainless steel<br>bracket, silk-screen printed tempered glass  |

## CARATTERISTICHE GENERALI | GENERAL FEATURES

|   |   |
|---|---|
| TEMPERATURA DI ESERCIZIO<br>OPERATING TEMPERATURE | -10°C +45°C   |
| GRADO DI PROTEZIONE   INGRESS PROTECTION          | IP67  |
| GRADO DI RESISTENZA   IMPACT RESISTANCE           | IK07  |
| GLOW WIRE TEST   GLOW WIRE TEST                   | 960°C   |
| TEMPERATURA SCHERMO<br>SCREEN TEMPERATURE         | 40° @ Ta = 25°  |
| CLASSE DI ISOLAMENTO   APPLIANCE CLASS            | III   |
| CALPESTABILE   WALKOVER                           | /   |
| CARRABILE   DRIVE OVER                            | /   |
| CAVI DI ALIMENTAZIONE   POWER CABLES              | Fornito con 50 cm di cavo   Provided with 50 cm cable |
| SICUREZZA STANDARD   STANDARD SAFETY              | WP System   |
| SICUREZZA FOTOBIOLOGICA<br>PHOTOBIOLOGICAL SAFETY | GR1   |

## GOLIA

## ACCESSORI | ACCESSORIES

|                             |   |
|-----------------------------|---|
| <b>CODICE / CODE</b>        | <b>PL006</b>  |
| <b>TIPOLOGIA / TYPOLOGY</b> | <b>Paralume<br/>Shade</b>  kg 0,30 |
| <b>MATERIALE / MATERIAL</b> | <b>Acciaio inox AISI 304</b><br><i>AISI 304 Stainless steel</i>   |

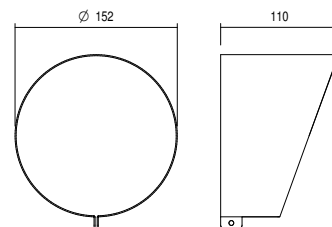

|                             |  |
|-----------------------------|--|
| <b>CODICE / CODE</b>        | <b>ST017</b>   |
| <b>TIPOLOGIA / TYPOLOGY</b> | <b>Staffa verniciata<br/>Varnished bracket</b>  kg 0,28 |
| <b>MATERIALE / MATERIAL</b> | <b>Acciaio inox AISI 316L</b><br><i>AISI 316L Stainless steel</i>  |

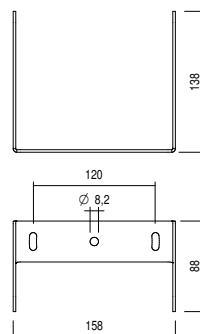

|                             |  |
|-----------------------------|--|
| <b>CODICE / CODE</b>        | <b>PI002</b>   |
| <b>TIPOLOGIA / TYPOLOGY</b> | <b>Picchetto<br/>Peg</b>  kg 0,10 |
| <b>MATERIALE / MATERIAL</b> | <b>Acciaio inox AISI 304</b><br><i>AISI 304 Stainless steel</i>  |

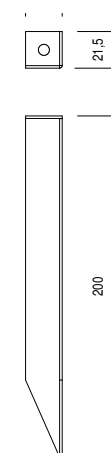

|                             |  |
|-----------------------------|--|
| <b>CODICE / CODE</b>        | <b>CIN20</b>   |
| <b>TIPOLOGIA / TYPOLOGY</b> | <b>Cinghia di fissaggio<br/>Mounting Strap</b>  kg 0,11                 |
| <b>MATERIALE / MATERIAL</b> | <b>Nastro in poliestere, fibbia in<br/>acciaio zincato, bassetta in AISI<br/>304</b><br><i>Polyester tape, zinc plated steel<br/>buckle, AISI 304 base</i> |

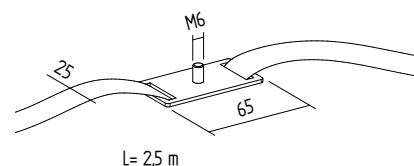

|                             |  |
|-----------------------------|--|
| <b>CODICE / CODE</b>        | <b>HC</b>                                    |
| <b>TIPOLOGIA / TYPOLOGY</b> | <b>Filtro Honeycomb<br/>Honeycomb filter</b> |

